



301 N. Hillcrest  
Sulphur Springs, TX 75482

2000 I-30 E  
Greenville, TX 75402

108 W. Marble  
Wylie, TX 75098

Wednesday, July 21, 2021

Office of Hopkins County Judge  
PO Box 288  
Sulphur Springs TX 75483

Farmers Electric Cooperative Member: JUDITH LEON  
Service Order Number: 2021072842

Greetings:

Farmers Electric Cooperative, Inc. is requesting permission to construct electrical power distribution facilities which will cross County Road 1130 which is located 1.5 miles east of CR 3216 in Hopkins County, Texas.

Site location map and construction sketches are enclosed. The construction sketch details the proposed work. All road crossings will have a minimum vertical clearance of 22 feet.

If you have any questions, please contact me at any time.

Sincerely,

*Cody Bland*

Project Coordinator  
cbland@farmerselectric.coop  
Phone 903-456-1722

Submitted by Brandon Darrow  
bdarrow@farmerselectric.coop  
Field Engineering Coordinator

Enclosures

County Approval Section:

Approved:

Denied:

Authorized Signature: \_\_\_\_\_

Date: 7/22/21

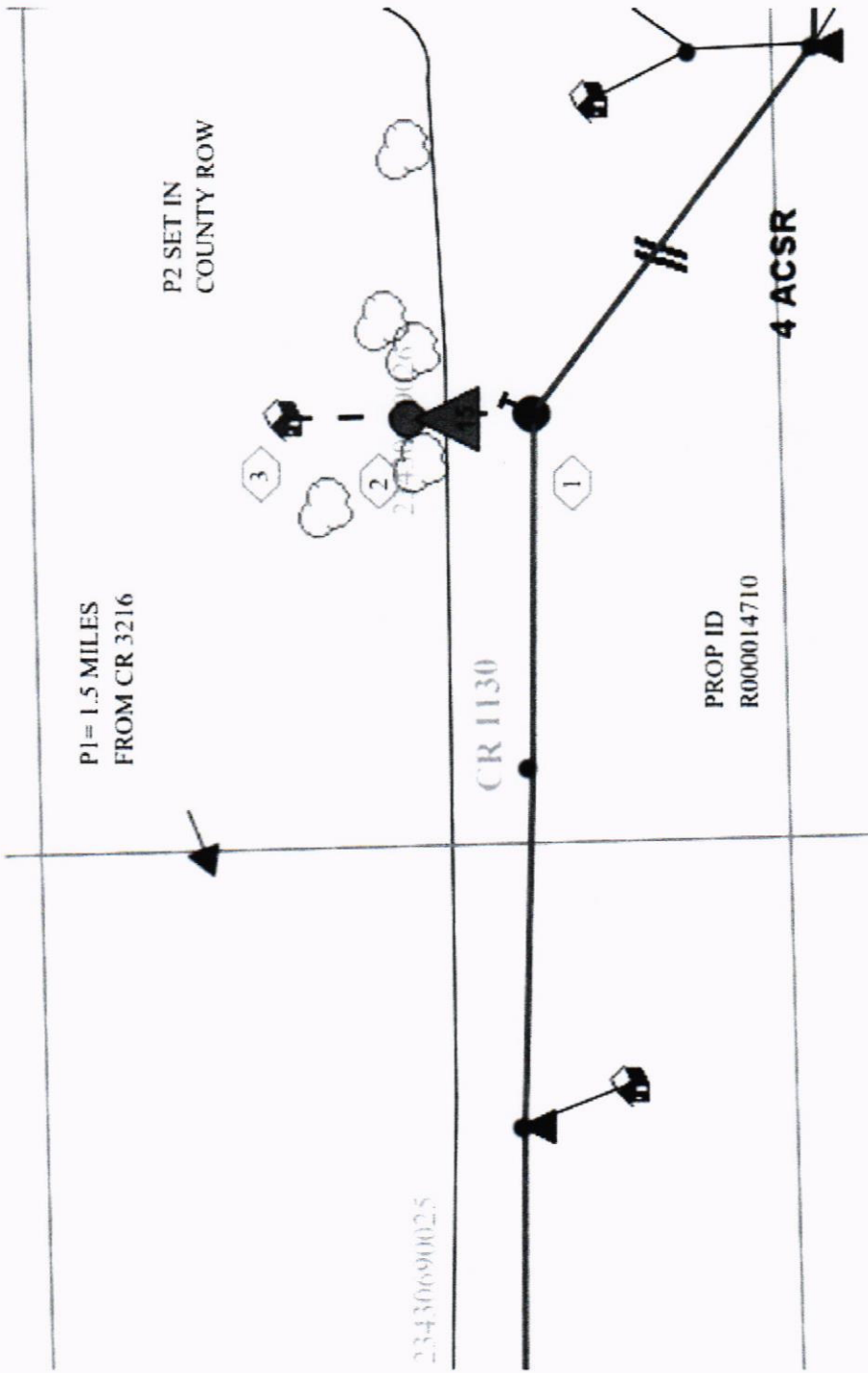

Judith Leon  
Service Order#  
2021072842  
Cross CR 1130 at Pole#  
056888

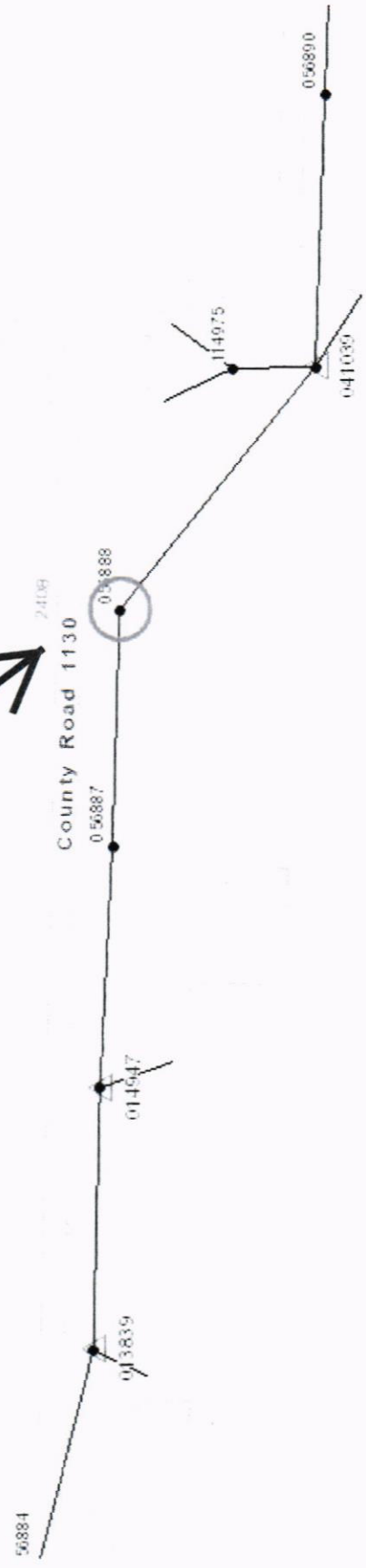
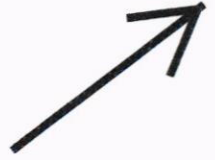

Hughes Creek

Hughes